

# TOSHIBA

## B-852

### MID-RANGE PRINTER

#### Product brochure

- > With powerful networking capabilities, the B-852 wide web printer from Toshiba delivers exceptional performance for a wide variety of environments and applications.
- > This innovative industrial printer offers superior features including extremely fast processing, large internal memory, web printer controls and outstanding SNMP networking tools.



**TOGETHER**  
**INFORMATION**

## APPLICATIONS

The TOSHIBA B-852 printer with exceptional performance and the ultimate in networking tools with impressive capacity to adapt to various working environments.

- > Manufacturing
  - to print carton labels, rating labels, picking labels, parts labels etc.
- > Transport and Logistics
  - to print shipping/receiving labels, address labels, pallet labels etc.
- > All industries which need to process and print large label sizes at high speed
  - e.g. Automotive, Heavy Industry, Steel Industry, Paper Industry, Forestry, Chemical Industry, Pharmaceutical Industry, Textile Industry, Retail Distribution

### Speed and Functionality

Utilising field-proven CPU technology from Toshiba, the B-852 offers high-speed printing and enhanced processing via an extensive choice of interfaces – including USB 2.0 and internal LAN. The options of serial and LAN interfaces provide additional flexibility and choice, making the B-852 adaptable to the widest variety of environments and applications.

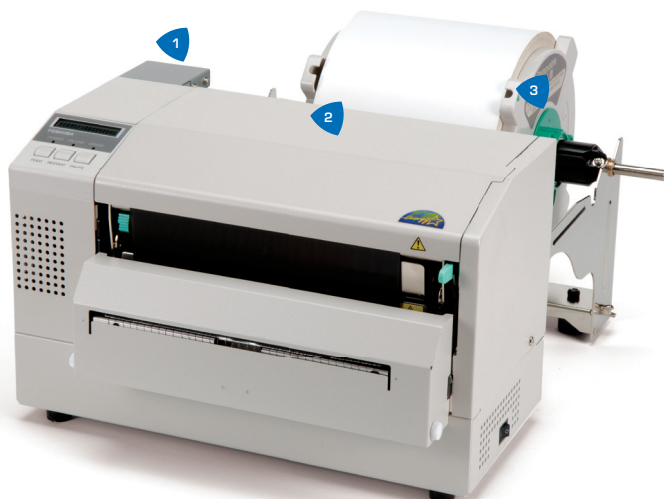
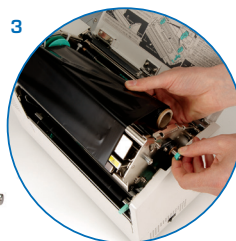
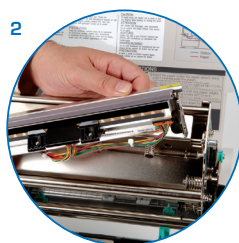

## POWERFUL PRINTING

### High Print Quality

The B-852 300 dpi, 216 mm wide printhead facilitates rapid printing of high-quality, large format compliance labels.

### Future Proofing

For future proofing, the B-852 printer is compatible with legacy systems. With the powerful Basic Command Interpreter (BCI) programme, incoming data can be manipulated to generate the correct label formats. The BCI can also communicate with external devices allowing the easy integration of other technology systems.

### SNMP Tools

The B-852 comes with a free Network Management Suite that allows the user to:

- > Manage all the Toshiba printers attached to the network through their IP address.
- > Display system information and firmware versions, allowing firmware to be updated across the network simultaneously.
- > View the status of each individual printer connected to the network in real time with real-time alerts (including viewing web pages).
- > View a graphical display of the alerted error with the instructions necessary to resolve it, even emailing the service call centre number when needed.

### Lower Cost of Ownership

Manufactured at Toshiba's own facilities this printer provides the assurance of complete reliability and quality of key components, which is essential for low overall cost of ownership (TCO). To lower the TCO even further the B-852 has large internal memory as standard with no requirement for additional memory.

# SPECIFICATIONS

## General

<b>Print Method</b>	Thermal transfer/Direct thermal
<b>Printhead</b>	Flat head
<b>Dimensions (W x D x H)</b>	385 x 181 x 243 mm 429 x 427 x 265 mm with supply holder installed
<b>Weight</b>	15.6 kg
<b>Memory</b>	16 MB (FROM), 16 MB (SRAM)
<b>User interface</b>	LCD (16 digits), 3 x LED, 3 x key
<b>Operating Temperature / Humidity</b>	5°C to 40°C / 25-85% non condensing relative humidity (RH)
<b>Storage Temperature / Humidity</b>	-40°C to 60°C / 10-90% non condensing relative humidity (RH)
<b>Power Supply</b>	AC 100 to 240 V, 50/60 Hz

## Print

<b>Resolution</b>	300 dpi (11.8 dots/mm)
<b>Sensor</b>	Reflective, Transmissible
<b>Maximum Print Speed</b>	101.6 mm/second (4 ips)
<b>Maximum Print Width</b>	216.8 mm
<b>Print Length</b>	Batch: 12.5-640 mm Cut: 32-640 mm
<b>Barcodes</b>	UPC/EAN/JAN, Code 39, Code 93, Code 128, EAN 128, NW7, MSI, Interleaved 2 of 5, Industrial 2 of 5, Matrix 2 of 5, Postnet, RM4SCC, KIX-Code, Customer Barcode, GS1 Databar
<b>2D Codes</b>	Data Matrix, PDF417, QR Code, Maxi Code, Micro PDF417, CP Code
<b>Fonts</b>	Bitmap font, Outline font, Writable characters, TTF

## Ribbon

<b>Ribbon Width</b>	120-220 mm
<b>Ribbon Core Size</b>	25.4 mm (1 inch)
<b>Fixed Core Length</b>	240 mm
<b>Max. Ribbon Length</b>	300 m
<b>Max. Ribbon Diameter</b>	72 mm

## Media

<b>Alignment</b>	Centred
<b>Backing Paper Width</b>	Batch: 100-242 mm Cut: 100-235 mm
<b>Label Thickness</b>	0.13-0.18 mm
<b>Tag Thickness</b>	0.08-0.18 mm
<b>Inner Media Core Diameter</b>	38-76 mm
<b>Outer media Roll Diameter</b>	230 mm
<b>Media Type</b>	Vellum paper and labels, Matt coated paper, Glossy coated paper, Synthetic film, PET film, Polyimide
<b>Media Format</b>	Roll, Fanfold

## Software & Connectivity

<b>Printer Driver</b>	Windows 10/8/7/Vista (32/64 bit), Windows Server 2012/Server 2008 (32/64 bit)
<b>Interface</b>	USB 2.0 (Full Speed), LAN 10/100 Base, Parallel port, Serial port <sup>1)</sup>
<b>Language Mode</b>	TPCL, BCI (function)
<b>Label Software</b>	BarTender UltraLite



## Options

Cutter module, expansion I/O board, RS-232C board, RTC (real time clock)

<sup>1)</sup> Optional



## About Toshiba Tec

Toshiba Tec Corporation is a leading provider of information technology, operating across multiple industries - ranging from retail, education and business services to hospitality and manufacturing. With headquarters in Japan and over 80 subsidiaries worldwide, Toshiba Tec Corporation helps organisations transform the way they create, record, share, manage and display information.

For more information please contact us:

### Toshiba Tec Corporation

1-11-1, Osaki, Shinagawa-ku, Tokyo  
141-8562, Japan

### Website

[www.toshibatec.com](http://www.toshibatec.com)



**Together Information is Toshiba's vision for how people and organisations create, record, share, manage and display ideas and data.**

**It is based on our belief that the most successful organisations are those that communicate information in the most efficient way.**

**We make that possible through an integrated portfolio of industry-specific solutions, all of which reflect Toshiba's commitment to the future of the planet.**

